



DESIGN IS
PERSONAL™
AND EASY
WITH
LIGHTWEIGHT
DIY PRODUCTS

LIGHTWEIGHT DIY™ FLOOR PLANKS

• • • because transformation should be easy,
and change shouldn't be that hard.

VINYL PLANKS WITH A CLICK CONNECTION Installation Instructions

DIP CUSTOMER SERVICE
email: INFO@designispersonal.com

KEY INSTALLATION CONSIDERATIONS

TOOL RECOMMENDATIONS TO PROPERLY INSTALL DIP™ FLOOR PLANKS:

- Knife
- Pencil
- Ruler / measuring tape
- Strip cutter
- Spacers
- Bevel protractor

| | |
|--|---|
| Subfloor Flatness Tolerances | 5mm in 3 meters or 3mm in 1.8 meters |
| Damp Proof Membrane - 0,20 mm | Not required |
| Is underlayment (underlay) required | Only if subfloor insufficiently smooth – DIP™ flooring then requires an underlay-ment with a minimum compressive strength of 50kpa. |
| Acclimation Requirements | 24 hours* |
| Transition Requirements (T-Mould) for Large Spaces | Required in rooms greater than 20 meters in either direction |
| Transition Requirements (T-Mould) Doorways/Thresholds | Required |
| Installation over existing ceramic tile floor | Filling grout lines may be required, follow subfloor flatness requirements. |
| Glue Down Installation | Not required/Not recommended |
| Internal Subfloor Relative Humidity (RH) Recommendations | Maximum 85% RH when tested with a hygrometer, in accordance with BS 8203: 2001. Appendix A |
| Underfloor Heating | Approved Substrate surface temperature not to exceed 30oC |
| 3-Season/Non-Climate Controlled Environments | OK |
| Expansion Requirements | 5mm around perimeter walls & pipes** |
| Optimal Interior Environmental Conditions | During installation: 18oC During life of flooring: 12oC - 35oC /40% - 60% RH |
| Definition of "Waterproof" | Structural integrity of flooring will not degrade due to contact with moisture/water*** |

* DIP™ flooring is more dimensionally stable than typical floating wood or vinyl based flooring products, however acclimation is advisable. DIP™ flooring subjected to extremely cold conditions can cause the material to become too rigid, making it difficult to install and potentially causing damage to the locking system. Optimum material and building temperature range for installation is 18°C – 29°C (64°F–84°F).

** If installing DIP™ flooring in an environment that has a length or width greater than 20 meters, a T-Moulding should be utilized to separate the floor into two (2) separate sections.

*** While DIP™ flooring is waterproof, it is not intended for use as a moisture mitigation system.

ATTENTION: Only installation techniques described in this installation guide are warranted. DIP™ does not warrant DIP™ flooring installations involving custom cutting, such as 45-degree mitered corners and serpentine edges. Please refer to the DIP™ flooring warranty for complete warranty details and exclusions.



INSTALLATION FOR DIP™ FLOORING WITH DROP DOWN LOCKING PROFILE

Installation will move from left to right beginning in the left corner with tongue side of long edge facing the wall. First measure the distance between the starting wall and ending wall. It may be necessary to cut the first row to balance the layout and to prevent having a small cut at the end wall.

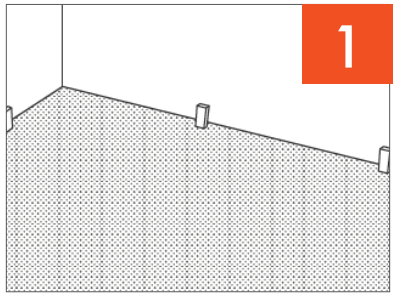

1

SET SPACERS

Create the required expansion space between the perimeter planks and the wall using spacers. Place spacers equalling the thickness for required expansion between plank and wall on short and long ends of plank.

Do not remove them until the installation is complete.

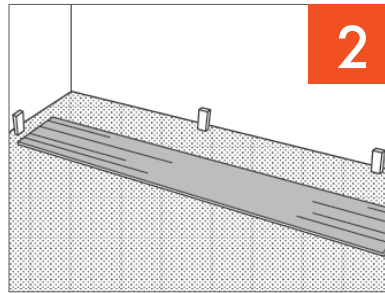

2

INSTALL FIRST PLANK

Position the first plank against a spacer a few millimetres from the starting wall.

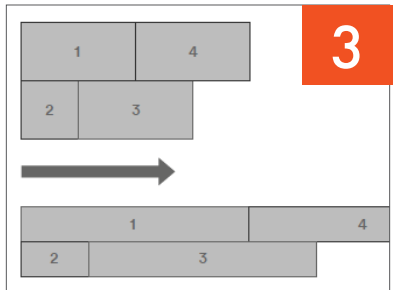

3

ESTABLISH PROPER STAGGERING

Position the first plank against a spacer a few millimetres from the starting wall.

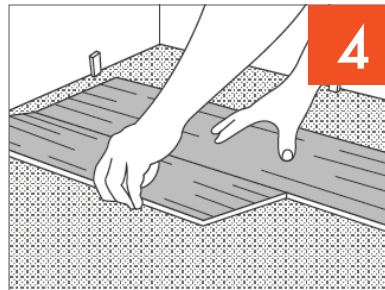

4

FIRST PLANK, SECOND ROW

Cut the first plank in the second row to one-third its length before installing it. Insert the long tongue edge of the plank into the long groove edge of the first plank. Make sure there are no gaps. Tap along the long groove edge using a tapping block.

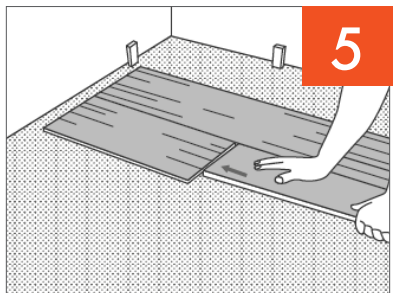

5

SECOND PLANK, SECOND ROW

Insert the long side then slide the plank until the short tongue touches the short groove edge on the first plank of the second row. Press the joint into place with your fingers and tap the short joint with a lightweight plastic hammer. Advised is a light colored rubber hammer with 45 diameter face and a weight of 350 grams. Square the joint by tapping the long edge of the plank using a tapping block, if necessary.

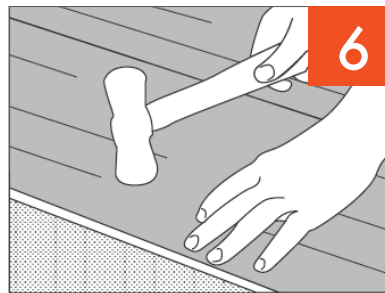

6

SECOND PLANK, FIRST ROW

Select a full plank and position the long groove edge into the tongue of the second plank in the second row. Press, tap and square as before. Repeat the same installation pattern until you reach the opposite wall and cannot install another full plank.

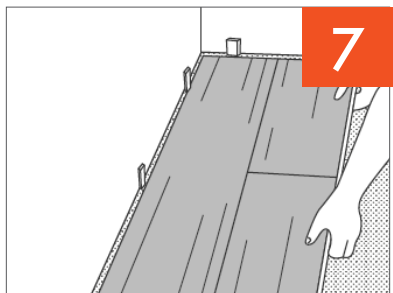

7

INSTALL THE LAST PIECES OF ROW 1 & 2

Cut to fit, maintaining the expansion gap. Install as before. Move the entire assembly against the spacers on the starting wall.

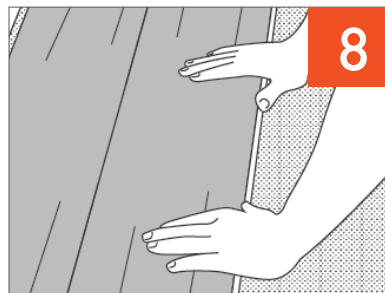

8

INSTALL REMAINING ROWS

Install the remaining material, one row after the other. Always press, tap and square as you go, and maintain the required stagger throughout the install.



9

INSTALL THE LAST ROW

Position the first plank against a spacer a few millimetres from the starting wall.

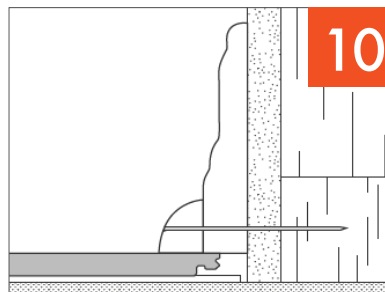

10

FINISH THE JOB

Remove spacers. Cover expansion space with skirting, quarter round or other trim, being sure not to trap or pin down the floor.

WARRANTY INFORMATION

Limited 15-Year Residential Warranty

DIP™ will furnish replacement flooring free of charge if there is a loss of original pattern and colour under normal residential and/or commercial use of DIP™ Floor Planks for the number of years as indicated below provided the flooring covered by this warranty is installed and maintained according to the instructions included in each package.

This warranty does not include damage due to improper installation or maintenance, excessive moisture or alkalis in the subfloor or conditions arising from hydrostatic pressure, burns, tears, indentations, stains or reduction in gloss due to normal use or exterior application.

This warranty shall not include loss of time, inconvenience, incidental expenses incurred in the removal or reinstallation of the affected material and any other incidental or consequential damages.

This warranty is in lieu of any other warranties, expressed or implied. The warranty service is only available by notice to DIP™, through the dealer from whom the purchase was made. Notification must be accompanied by a copy of the original invoice and can only be authorised by DIP™.

QUESTIONS ABOUT THIS WARRANTY

Questions about this warranty can be sent via email to info@designispersonal.com or mail to: DCF, LLC., 333 S. State St V-304, Lake Oswego, OR 97034, USA (postage to be paid by sender).

Alternatively, you can email Customer Service at info@designispersonal.com

Claims under this Limited Warranty must be made in writing to the same address.